



LOCATION AND PARKING

The Shops at The Bravern is conveniently located just off I-405 at the intersection of NE 8th Street and 112th Avenue NE in Bellevue, Washington. Self-parking is free for six hours with validation. No purchase necessary. Valet parking is also available.

SHOPPING HOURS



Monday-Saturday: 10:00am - 8:00pm

Sunday: 12:00pm - 6:00pm

Restaurant and amenity hours vary. Some retailers may have different hours

DIRECTORY OF STORES

商家名录

 Bravern
 TheBravern
 USATheBravern

TheBravern.com
#theBravern

 THE SHOPS AT THE
BRAVERN

LOWER LEVEL

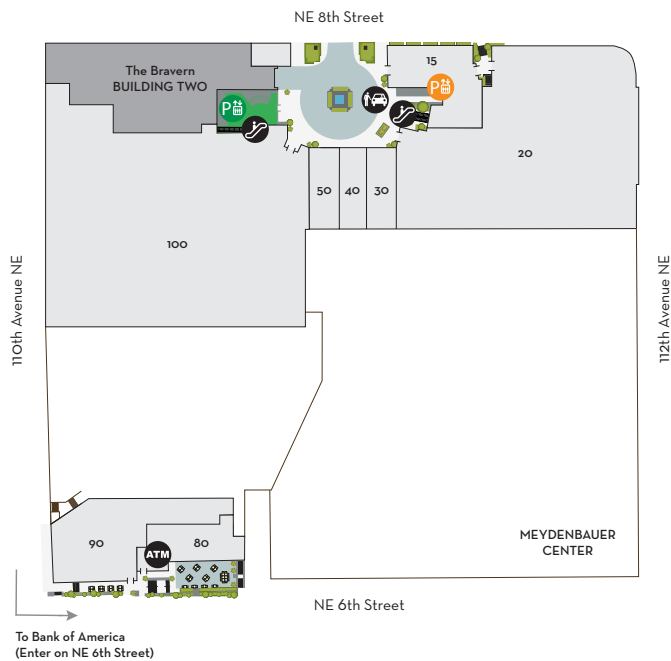

MAIN LEVEL

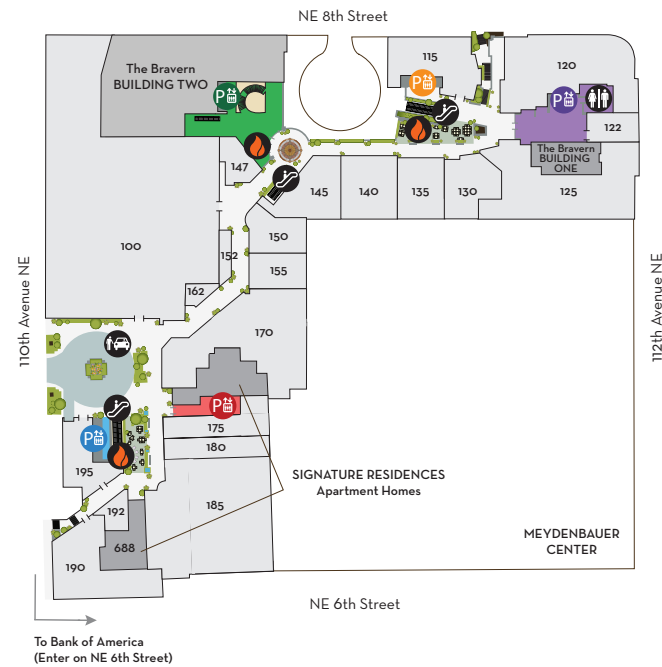

UPPER LEVEL

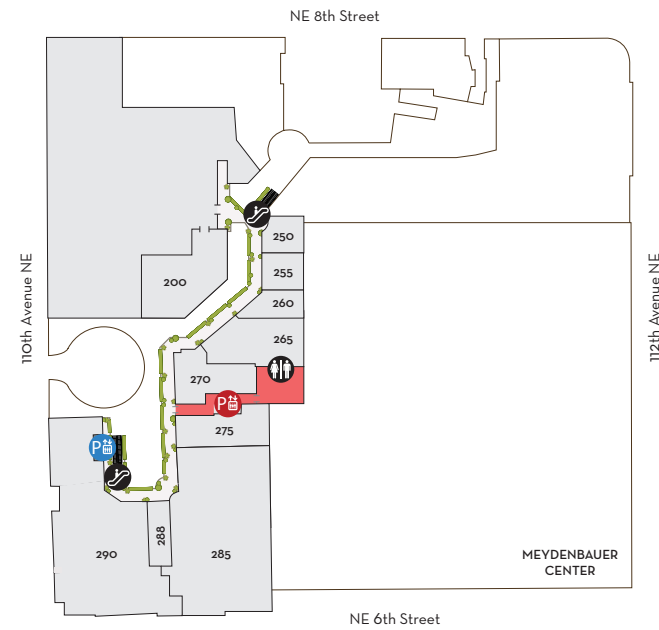

WELCOME TO THE SHOPS AT THE BRAVERN

Enjoy exploring this vibrant outdoor destination. Since the opening in 2009, The Shops at The Bravern has revolutionized the experience of one-stop dynamic and luxury shopping.

The Shops at The Bravern is the unrivaled destination for fashion and sophistication. Discover the prestigious brands including Hermès, Louis Vuitton, Gucci, Moncler, Omega, Prada and Bottega Veneta. Pamper yourself in the top-draw restaurants like John Howie Steak, The Dolar Shop (dòu lāo fǎng) and experience the most sought-after amenities including Gene Juarez Salon & Spa and Life Time Athletic.

SHOPS | 商店

- | | |
|---|---|
| <p>15/115 Hermès
425-467-0500
Handcrafted products of enduring quality and style.</p> <p>30 Bottega Veneta
425-201-3232
Iconic leather goods, accessories and shoes.</p> <p>50/145 Prada
425-637-5820
Apparel, handbags and fragrance.</p> <p>140 Louis Vuitton
425-453-6700
Leather goods and accessories for men and women.</p> <p>147 Oliver Peoples
425-455-0323
Stylish handcrafted eyewear.</p> <p>150 Omega
425-454-1242
The world's finest watches, with timeless aesthetic appeal.</p> | <p>152 APM Monaco
425-449-8515
Modern and minimal jewelry designs.</p> <p>155 David Lawrence
425-688-1669
Men's and women's fashions.</p> <p>162 Wolford
425-679-6855
Women's luxury legwear, ready-to-wear and lingerie.</p> <p>170 Gucci
425-454-1073
Luxury Italian fashion and leather goods.</p> <p>175 Moncler
425-635-9012
Absolute elegance in every detail of outdoor apparel.</p> <p>180 Tod's
425-455-6636
Italian-made shoes and leather goods for men and women.</p> <p>250 Holly Zhang Pearl Gallery
425-449-8332
Specialty pearl jewelry and accessories.</p> |
|---|---|

- | | |
|--|--|
| <p>255 Eye Society
425-453-9691
Exquisite eyewear personalized to your style.</p> | <p>195 Café Trophy - Trophy Cupcakes
206-632-7020
Cupcakes, pastries and cafe with a twist.</p> |
|--|--|

RESTAURANTS | 餐厅

- | |
|---|
| <p>122 Whiskey by John Howie
425-440-0880
The Eastside's whiskey and craft cocktail destination.</p> <p>125 John Howie Steak
425-440-0880
Award-winning Northwest steakhouse serving the world's best steaks.</p> <p>190 The Dolar Shop
425-390-8888
Upscale Chinese restaurant serving individual hotpots.</p> <p>192 Yifang Taiwan Fruit Tea
425-998-9220
Experience the old-fashioned Taiwanese premium tea made with love & real ingredients.</p> |
|---|

SERVICES | 服务

- | |
|---|
| <p>20 Life Time Athletic
206-712-7900
An athletic club offering members a unique and personalized approach to health and wellness.</p> <p>20 Bank of America
425-577-5280
Full service branch and 24 hour ATM.</p> <p>270 Compass
425-242-6440
Compass is streamlining the home buying and selling experience.</p> <p>290 Gene Juarez Salon & Spa
425-455-5511
Enhance beauty and well-being from cuts to colors and massage to skin care.</p> <p>Retail Management Office
Parking Level P1, at Amber Elevators
425-456-8795</p> |
|---|

SIGNATURE RESIDENCES 精品住宅

- 688 Apartment Homes & Leasing Center**
425-502-9748
South Tower

PARKING ELEVATORS 停车场电梯

- | | | |
|--|----------|-----|
| | Amber | 琥珀 |
| | Emerald | 绿宝石 |
| | Ruby | 红宝石 |
| | Sapphire | 蓝宝石 |
| | Amethyst | 紫水晶 |

LEGEND | 图例

- | | | |
|--|-----------|-------|
| | Restroom | 洗手间 |
| | Escalator | 自动扶梯 |
| | Fireplace | 壁炉 |
| | Valet | 礼宾泊车 |
| | ATM | 自动取款机 |

